



temporary protection system

**TEMP**

Perform a short-term task in safety



+43 7619 22 1 22 - 0  
+49 271 23 41 94 - 0  
+43 564 16 9 042 - 0

office@innotech.at  
www.innotech.at

Laizing 10  
A 4656 Kirchham

## TEMP temporary protection system

### Safety systems for temporary use

There are situations on construction sites or in industry where it is impossible to attach permanent fall protection.

The TEMP temporary protection system provides solutions for these special situations. Depending on the constructional circumstances and the area to be secured, there are both individual and collective fall protection systems which are very attractive because of rapid installation and dismantling. In addition, these can also be reused.



### BENEFITS

- Ideal for temporary deployment, because of rapid installation and dismantling.
- Flexible installation on various substructures, thanks to the "lashing strap" attachment.
- Can be reused because of the attachment method.

## Safety systems for temporary use



The mobile systems adapt themselves individually to very varied fastening options, such as round columns, steel constructions, wooden structures, etc. The fall protection systems are lashed down or clamped, and are therefore attached without intervention in substructures. High-quality materials selected as specified in standards ensure optimum safety.



### BENEFITS

- Rapid installation and dismantling by lashing down or clamping.
- Tested, durable materials ensure optimum safety.
- Individual and/or collective protection: Protection for one or more persons, depending on product and application.



### Installation possible without specific training

No special training is required for the temporary fall protection systems from INNOTECH.

#### Short-term fall protection - quick to install

The temporary fall protection systems are easy to transport, and are installed in a very short time, simply by lashing down or clamping.

#### Equipped for very varied situations

Round columns, wood or steel constructions, as well as skylights, can be reliably protected against falls, using the temporary solutions from INNOTECH.

### State of the art certification:

EN 795:2012 TYPES B and C  
CEN/TS 16415:2013  
GS-BAU-18  
EN 1263-1



### TEMP LIFELINE SYSTEM

TEMP temporary  
protection

For details see subsequent  
pages



### EAP-MOBI

LIGHT skylight protection  
system

For details see subsequent  
pages



## TEMP LIFELINE SYSTEM

TEMP temporary protection

The TEMP lifeline system from INNOTECH can be used everywhere that a horizontal surface must be temporarily protected against falls. The system can be used on construction sites, as well as for industrial structural developments with very varied support structures (steel, facade, warehouse, and bridge construction, etc.).

### BENEFITS

- Mobile lifeline system for special situations.
- Ideal for steel, facade, warehouse, and bridge construction.
- Adapts individually to very varied fastening options (round columns, steel structures, INNOTECH anchorage points).
- Simple and quick installation and dismantling, just using lashing strap.

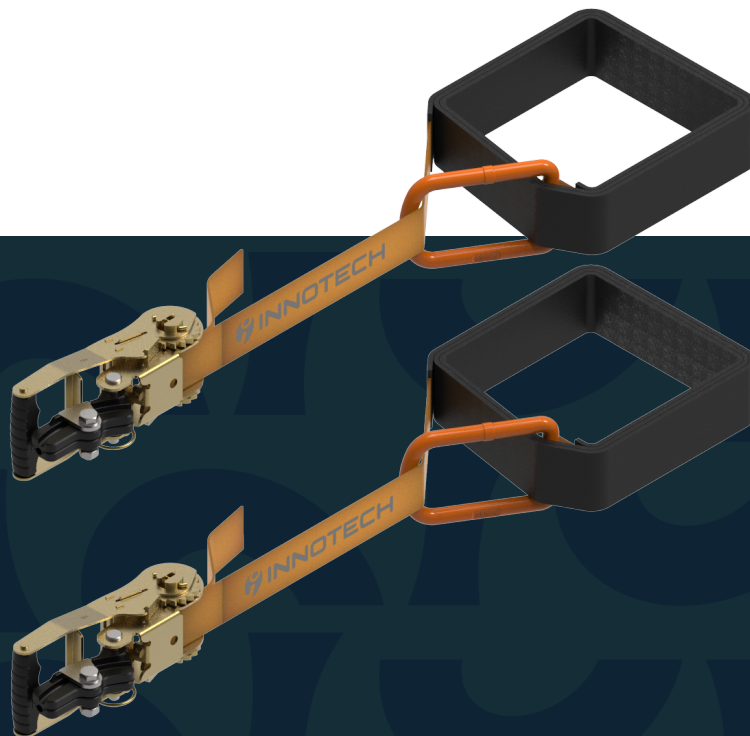

Currently no updates for this product

## Technical product description

The TEMP temporary lifeline system from INNOTECH is very simple and quick to install and dismantle, and is therefore especially suitable for short-term installation requirements. The delivery includes a stainless steel cable up to 150m in length. Practical: Up to 20 m separation between intermediate brackets achievable. A shock absorber on the end lock provides additional safety.



### TECHNICAL BENEFITS

- Braked cable pulley with up to 150 m stainless steel cable.
- End lock with integrated shock absorber.
- Wide span: Up to 20 m separation between intermediate brackets achievable.

### **State of the art certification:**

EN 795 TYP B und C

CEN/TS 16415

## Components

### TEMP-ENDS-10

End lock set, temporary ENDS-10

**Mountable on:** steel or concrete beam

**Application:** steel, facade or bridge construction

**Length of lashing strap:** 4 m

**Material:** aluminium (anodised), plastic, galvanised steel

complete set for one cable span (PU = 2 pcs.)  
can be quickly attached or detached at any point of the stainless steel cable (AIO-SEIL-30)  
can be mounted on steel or concrete beams with lashing straps



### TEMP-SZH-10

Intermediate bracket SZH-10 for lifeline system

**Mountable on:** steel or concrete beam

**Application:** steel, facade or bridge construction

**Length of lashing strap:** 2.5 m

**Material:** aluminium (anodised), plastic, galvanised steel

can be mounted to steel or concrete beams with lashing straps (PU = 1 pce.)



### TEMP-HASPEL-10

Mobile cable pulley HASPEL-10

**Material:** stainless steel (AISI 316), galvanised steel  
cable drum with brakes for practical roll up of the stainless steel cable (AIO-SEIL-30)

TEMP-HASPEL-10-150 incl. 150 m stainless steel cable, weight c. 80 kg



### PSA-BRAKE

Lanyard PSA-BRAKE

**Lengths:** 2 / 5 / 10 / 15 / 20 / 25 m

**PSA-BRAKE-2 without integrated shock absorber for:**  
restraint system (EN 354)  
positioning system (EN 358)

**off PSA-BRAKE-5 with integrated shock absorber for:**  
fall arrest system / restraint system (EN 353-2)  
positioning system (EN 358)  
temporary horizontal lifeline system (EN 795)



### PSA-SHARK

Lanyard PSA-SHARK

**Length:** 2 / 5 / 10 / 15 m

**PSA-SHARK-2 without integrated shock absorber:**  
restraint system (EN 354)  
positioning system (EN 358)

**Off PSA-SHARK-5 with integrated shock absorber:**  
fall arrest system / restraint system (EN 353-2)  
positioning system (EN 358)  
temporary horizontal lifeline system (EN 795)

Edge tested according to prEN 354:2008 Annex A and CNB11/P/11.054!



## Accessory items

### BEF-412

Fastening BEF-412

**Material:** galvanised steel

**Flange thickness:** 10 to 40 mm

**Width of steel beam:** 125 up to 415 mm

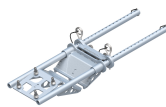

## EAP-MOBI

### LIGHT skylight protection system

The EAP-MOBI skylight fall-through protection system from INNOTECH can be used as fall-through protection, and also as a single anchor point for one person. This enables a person positioned on a skylight to move safely, starting from the skylight. It guarantees ideal safety, especially for clearing or maintenance work, and is extremely practical and simple to use, because it is fitted simply over the skylight using a net and lashing strap.

#### BENEFITS

- For temporary protection of skylights – not a permanent solution.
- Simple and fast installation thanks to net and lashing strap.
- Attached by a lashing strap to the skylight – causes no damage to the skylight.
- Optimum for protection during brief tasks on the roof.

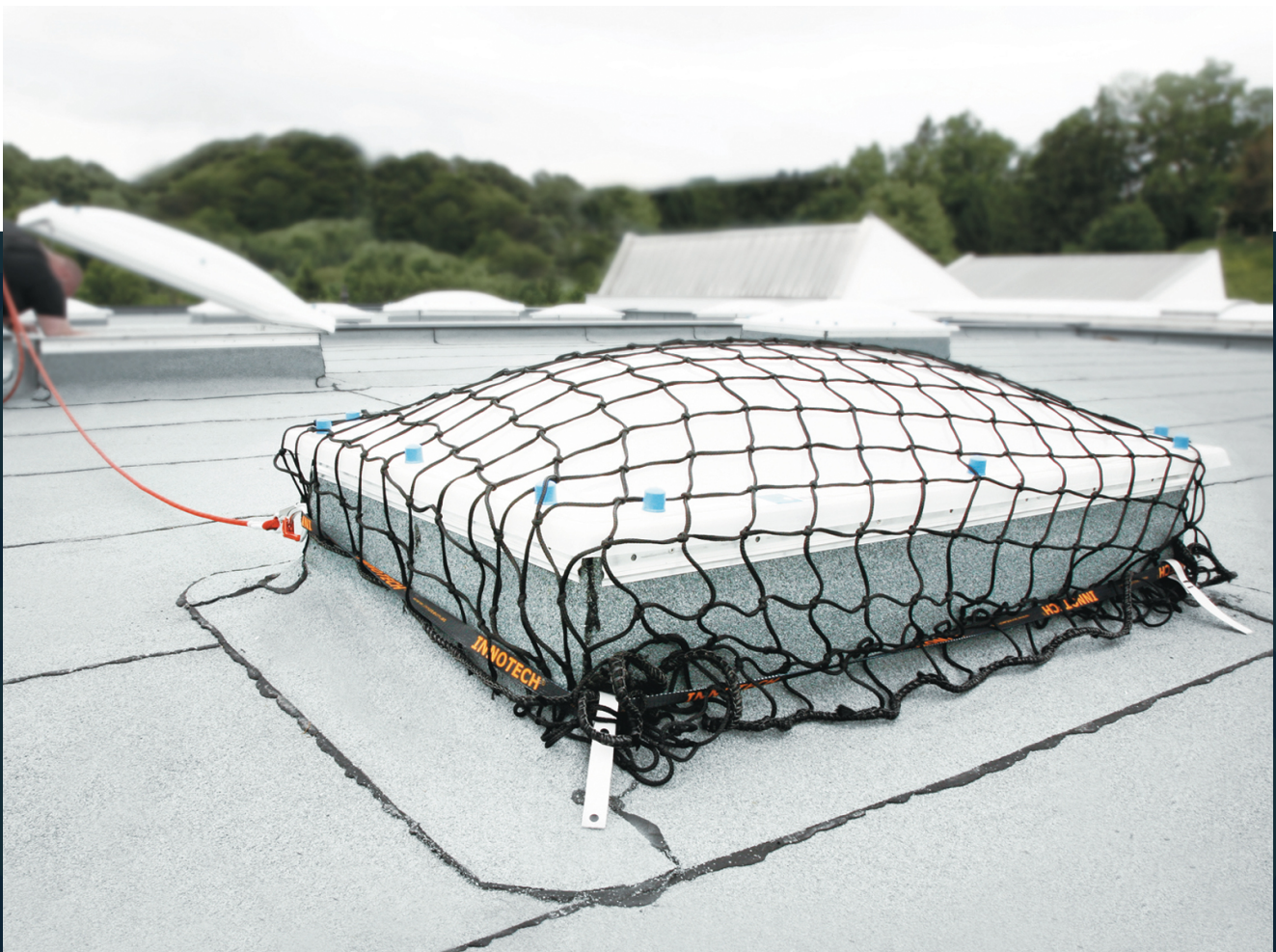

## Technical product description

The EAP- MOBI mobile skylight fall-through protection from INNOTECH, made from high-strength polypropylene, is used both as a fall-through protection system, and also as a single anchor point for one person. Attachment to the skylight is made simply and quickly by throwing the net over the skylight, and tightening the lashing strap.



### TECHNICAL BENEFITS

- Also tested and certified as a single anchor point of Class B for 1+1 person.
- Rapid inspection by means of test threads which are sent in for assessment.
- Available in two models (for skylights no larger than 1.5 x 1.5m and 2.7 x 2.7m).

### State of the art certification:

GS-BAU-18

EN 1263-1

EN 795:2012 TYP B

## Components

### EAP-MOBI-TAPE-13

Single anchor point MOBI-TAPE-13

**Length:** 13 m (max. size of skylight 2,7 x 2,7 m)

**Material:** plastic, galvanised steel

ashing strap can be used as an anchorage point EAP!



### EAP-MOBI-TAPE-9

Single anchor point MOBI-TAPE-9

**Length:** 9 m (max. size of skylight 1,7 x 1,7 m)

**Material:** plastic, galvanised steel

ashing strap can be used as an anchorage point EAP!





Head office  
**INNOTECH® Arbeitsschutz GmbH**

Laizing 10  
A 4656 Kirchham  
T +43 7619 22 1 22 - 0  
[office@innotech.at](mailto:office@innotech.at)  
[www.innotech.at](http://www.innotech.at)

Branch Office Switzerland  
**INNOTECH® Arbeitsschutz GmbH**

Seestraße 14b  
CH 5432 Neuenhof  
T +41 56 41 69 040  
[office@innotechag.ch](mailto:office@innotechag.ch)  
[www.innotechag.ch](http://www.innotechag.ch)

Branch Germany  
**INNOTECH® Arbeitsschutz GmbH**

In der Steinwiese 5  
D 57074 Siegen  
T +49 271 23 41 94 - 0  
[office@innotech.de](mailto:office@innotech.de)  
[www.innotech.de](http://www.innotech.de)