



Guardrail system  
**BARRIER**

**Vario-system**

Guardrail system with weights as superimposed load



+43 7619 22 1 22 - 0  
+49 271 23 41 94 - 0  
+43 564 16 9 042 - 0

office@innotech.at  
www.innotech.at

Laizing 10  
A 4656 Kirchham



## BARRIER-VARIO

Guardrail system with weights as superimposed load

The BARRIER-VARIO guardrail system is used wherever the fall edges of a flat roof up to a maximum pitch of 10° must be **protected**. The guardrail held in place by superimposed concrete weights creates a barrier around the fall-risk area, and thus ensures optimum fall protection for everyone located on the flat roof. The substructure is of no significance for fastening the guardrail system. With this system, roof penetrations are a thing of the past. The guardrail system was designed to ensure rapid and simple installation.

### BENEFITS

- Efficient installation thanks to the post separations of 2,5 m and a practical solution for corners.
- No impairment of the roof's various sheet layers, thanks to our foot units with an included release layer.
- Compensation of roof height differences up to 12,5 cm, thanks to simple height adjustment of the foot.
- Optimised user-friendliness, thanks to stackable concrete weights, each of 12,5 kg per side, and 100 % plasticiser-free.

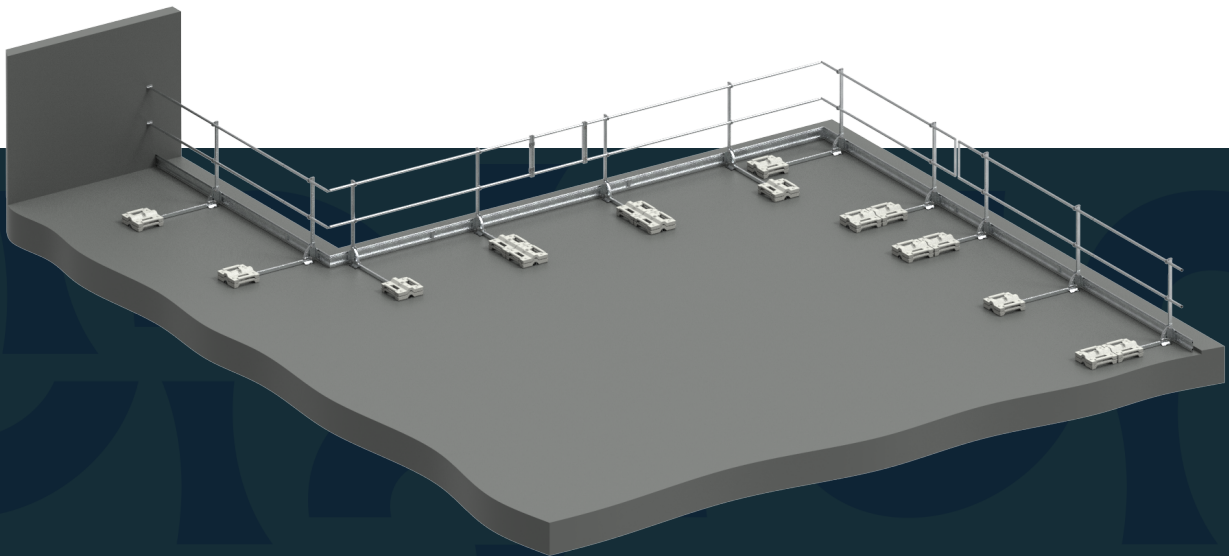

New economical variant with the BARRIER-V14 foot and an additional post with height adjustment up to 8 cm, and the option to incline the guardrail by 75°.

DIN 14094-2:2017

## Components

### BARRIER-Z11

Rating plate BARRIER-Z11 for guardrail system

**Material:** Aluminium composite, plastic  
for marking a BARRIER system



### BARRIER-V20

Vario weight BARRIER-V20

**Height x width x length:** 93 x 390 x 390 mm

**Weight:** 12,5 kg

**Material:** Beton



### BARRIER-S22-450

Standard boom, corner formation, BARRIER-S22-450

**Length:** 450 mm

**Material:** aluminium

Standard boom for System VARIO, corner formation  
customised lengths on request!



### BARRIER-S22-750

Standard boom BARRIER-S22-750

**Length:** 750 mm

**Material:** aluminium

Standard boom for System BARRIER-VARIO



### BARRIER-S22-1300

Standard boom BARRIER-S22-1300

**Length:** 1300 mm

**Material:** aluminium

Standard boom for System VARIO, escape route  
according to plan  
customised lengths on request!



### BARRIER-S12-1500

Standard boom, superimposed load, BARRIER-S22-15

**Length:** 1500 mm

**Material:** aluminium

Standard boom for System VARIO-load-bearing  
Customised lengths on request!



### BARRIER-V12

Vario foot unit BARRIER-V12

**Material:** aluminium, stainless steel (AISI 304)  
VARIO foot unit without boom/post, for creation of a  
load-bearing collective side protection



### BARRIER-V14

Vario foot unit BARRIER-V14

New

**Material:**

VARIO foot unit without boom/post, for creation of a  
load-bearing collective



### BARRIER-V92

Vario corner tie BARRIER-V92

**Material:** aluminium, stainless steel V2A (AISI 304)  
To connect two booms



### BARRIER-F20

Toe board BARRIER-F20

**Height x width x length:** 170 x 20 x 3000 mm

**Material:** aluminium

For use when no parapet higher than 150mm is  
available!

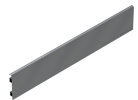

### BARRIER-F22

Toe board bracket BARRIER-F22

**Material:** aluminium, stainless steel (AISI 304)  
for fastening the BARRIER-F20 toe board to the VARIO  
BARRIER-V12 foot unit



### BARRIER-F23

Toe board connection set BARRIER-F23

**Packing unit:** 1 items

**Material:** aluminium, stainless steel (AISI 304)  
for connecting two BARRIER-F20 toe boards





# Components

## BARRIER-F25

Toe board bracket BARRIER-F25

**Material:** aluminium, stainless steel (AISI 304)  
for fastening the BARRIER-F20 toe board to the VARIO  
BARRIER-V14 foot unit



## BARRIER-S20-1140

Standard post BARRIER-S20-1140

**Length:** 1140 mm

**Material:** aluminium, aluminium-zinc, stainless steel  
Standard post for System VARIO including pipe retainer.



## BARRIER-S24-1140

Foldable post BARRIER-S24-1140

New

**Length:** 1140 mm

**Material:** aluminium, aluminium-zinc, stainless steel  
Foldable post including pipe retainer.



## BARRIER-S25-1150

Curved post BARRIER-S25-1150

New

**Length:** 1150 mm

**Angle:** 75°

**Material:** aluminium, aluminium-zinc  
urved post including tube holder for BARRIER-V14.



## BARRIER-T30

Door set BARRIER-T30

**Material:** aluminium, stainless steel (AISI 304)  
Opening 800 mm, anchorage direction fixed, not  
selectable (right hand door)  
For load-bearing implementation, 4 x BARRIER-V20  
weights required for each door side!



## BARRIER-R11

Aluminium pipe BARRIER-R11

**Diameter x wall thickness x length:** 36 x 2.5 x 3000 mm

**Material:** aluminium



## BARRIER-R21

Linear tie BARRIER-R21

**Material:** aluminium, stainless steel (AISI 304)  
for connecting two BARRIER-R11 pipes



## BARRIER-R31

Corner tie BARRIER-R31

**Material:** aluminium, stainless steel (AISI 304)  
Create a corner with two pipes BARRIER-R11  
Angle free adjustable!



## BARRIER-R41

Wall tie BARRIER-R41

**Substructure:** concrete or steel construction  
**Material:** aluminium, stainless steel (AISI 304)  
Angle free adjustable!



## BARRIER-R51

End seal BARRIER-R51

**Material:** aluminium, stainless steel (AISI 304)  
end seal of two rail pipes BARRIER-R11  
Projection of the rail pipe max. 500 mm!



## BARRIER-R91

End cap BARRIER-R91

**Diameter x thickness:** 36 x 2 mm

**Packaging unit:** 2 pieces

**Material:** plastic  
end cap for rail pipe BARRIER-R11  
Projection of the rail pipe max. 350 mm!



## Components

### BARRIER-Z22

End cap BARRIER-Z22

**Material:** zinc-aluminium  
End cap to cover a standard post



### BARRIER-R70

Pipe bracket BARRIER-R70

**Material:** zinc-aluminium, stainless steel  
pipe retainer to fix the pipes BARRIER-R11



## Accessory items

### BARRIER-Z31

Flame scarf angle BARRIER-Z31

**Material:** aluminium  
**Packaging unit:** 1 piece  
for holding a VARIO-weight BARRIER-V20 in position  
Per BARRIER-V20 min. 2 pieces of BARRIER-Z31  
required!



### BARRIER-Z35-500

Underlay mat Z35-500

**Height x width x length:** 4 x 500 x 500 mm  
**Material:** Fiber blend of polyester and polypropylene  
regenerated fibers  
**Packing unit:** 1 item  
underlay mat for one VARIO-BARRIER-V20



### BARRIER-Z33-500

Underlay mat Z33-500

**Height x width x length:** 3 x 500 x 500 mm  
**Material:** polyurethane  
**Packing unit:** 1 item  
underlay mat for one VARIO-BARRIER-V20





Head office  
**INNOTECH® Arbeitsschutz GmbH**

Laizing 10  
A 4656 Kirchham  
T +43 7619 22 1 22 - 0  
[office@innotech.at](mailto:office@innotech.at)  
[www.innotech.at](http://www.innotech.at)

Branch Office Switzerland  
**INNOTECH® Arbeitsschutz GmbH**

Seestraße 14b  
CH 5432 Neuenhof  
T +41 56 41 69 040  
[office@innotechag.ch](mailto:office@innotechag.ch)  
[www.innotechag.ch](http://www.innotechag.ch)

Branch Germany  
**INNOTECH® Arbeitsschutz GmbH**

In der Steinwiese 5  
D 57074 Siegen  
T +49 271 23 41 94 - 0  
[office@innotech.de](mailto:office@innotech.de)  
[www.innotech.de](http://www.innotech.de)