



Guardrail system
BARRIER

Parapet

Guardrail system installed on parapet



+43 7619 22 1 22 - 0
+49 271 23 41 94 - 0
+43 564 16 9 042 - 0

office@innotech.at
www.innotech.at

Laizing 10
A 4656 Kirchham

BARRIER-ATTIKA

Guardrail system installed on parapet

The BARRIER PARAPET guardrail system is suitable only for combination with an existing parapet construction. Once the system has been attached to the parapet construction, it provides optimum fall protection for all persons located on the roof. There are many attachment options for the guardrail system, and so an optimum solution can be found for every situation. The BARRIER PARAPET's various feet ensure an optimum visual result. For example, one of the feet also allows the system to be folded down completely, and then folded back up.

BENEFITS

- Optimum result thanks to various installation options on the parapet (at the side and on top).
- No additional load on the structure of the flat roof, thanks to direct installation on the parapet.
- Visually matching overall appearance thanks to various models (also foldable if required).
- Efficient installation and few roof penetrations, thanks to post separations of 2,5 m.

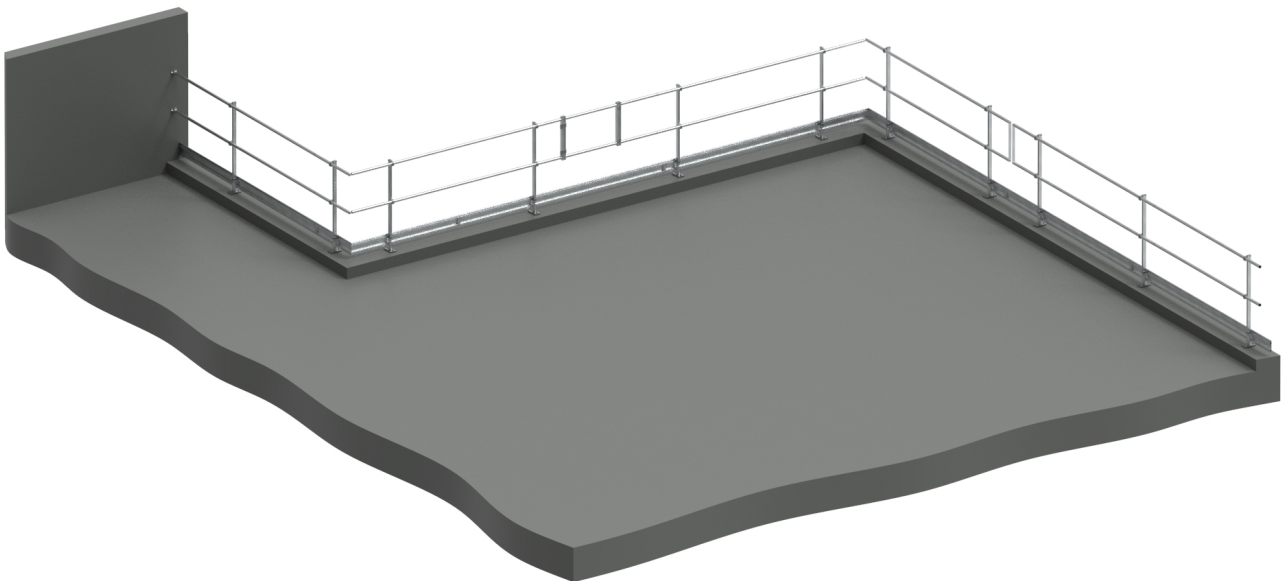

Currently no updates for this product

Technical product description

The guardrail system consisting of aluminium and stainless steel impresses because of its weather resistance and robustness. The guardrail, together with the various individual components, such as the specially developed foot units and posts, combine to create a harmonised system. Because installation takes place directly on the parapet, the roof is not subjected to an additional load.



TECHNICAL BENEFITS

Optimum result

There are various options for installing the guardrail system, such as installation on the side or top of the parapet. It is thus possible to achieve an optimum visual result appropriate to the actual circumstances.

Reduction of installation effort

From a financial aspect, the wide post separations of 2,5 m have a positive effect on the overall installation process.

Secured access

By fitting the optional BARRIER-T30 door set, optimally secured access and descent to or from the flat roof are made possible.

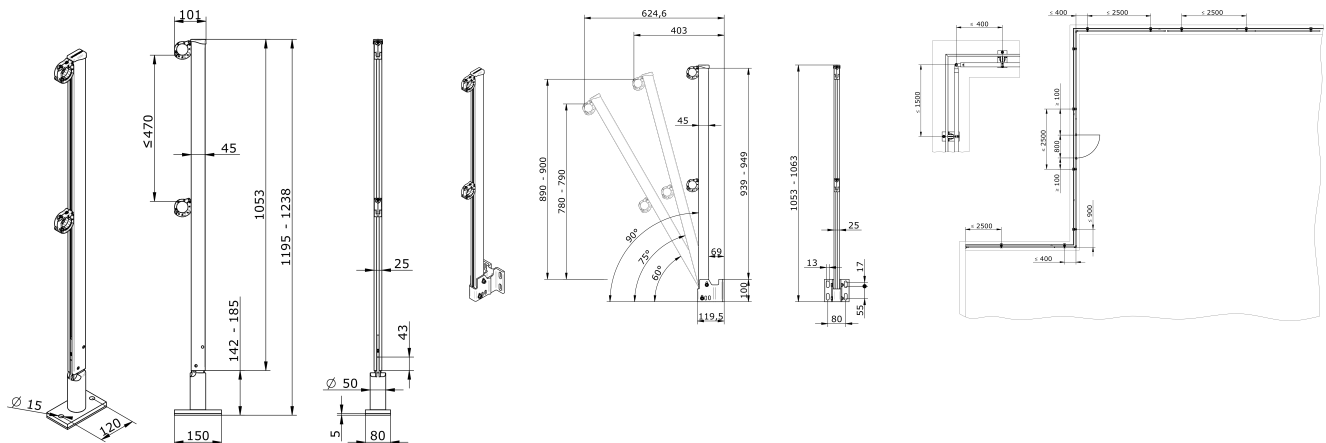

State of the art certification:

EN 13374:2019

DIN EN 14122-3:2016

DIN 14094-2:2017

Components

BARRIER-Z11

Rating plate BARRIER-Z11 for guardrail system

Material: Aluminium composite, plastic
for marking a BARRIER system

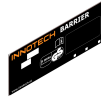

BARRIER-A22

Adapter BARRIER-A22

Substructure: concrete, steel construction
Effective height: 137 mm
Material: aluminium, stainless steel (AISI 304)
for fastening the post BARRIER-S21 to the top of the
parapet



BARRIER-F20

Toe board BARRIER-F20

Height x width x length: 170 x 20 x 3000 mm
Material: aluminium
For use when no parapet higher than 150mm is
available!



BARRIER-F21

Toe board bracket BARRIER-F21

Height x width: 25 x 48 mm
Packing unit: 2 items
Material: aluminium, stainless steel (AISI 304)
for attachment of the BARRIER-F20 toe board to the
BARRIER-S21 post



BARRIER-F23

Toe board connection set BARRIER-F23

Packing unit: 1 items
Material: aluminium, stainless steel (AISI 304)
for connecting two BARRIER-F20 toe boards



BARRIER-S21-1050

Standard post, parapet, BARRIER-S21-1050

Length: 1050 mm
Material: aluminium, aluminium-zinc, stainless steel
Standard post for System ATTIKA including pipe
retainer.



BARRIER-T30

Door set BARRIER-T30

Material: aluminium, stainless steel (AISI 304)
Opening 800 mm, anchorage direction fixed, not
selectable (right hand door)
For load-bearing implementation, 4 x BARRIER-V20
weights required for each door side!



BARRIER-R11

Aluminium pipe BARRIER-R11

Diameter x wall thickness x length: 36 x 2.5 x 3000 mm
Material: aluminium



BARRIER-R21

Linear tie BARRIER-R21

Material: aluminium, stainless steel (AISI 304)
for connecting two BARRIER-R11 pipes



BARRIER-R31

Corner tie BARRIER-R31

Material: aluminium, stainless steel (AISI 304)
Create a corner with two pipes BARRIER-R11
Angle free adjustable!



BARRIER-R41

Wall tie BARRIER-R41

Substructure: concrete or steel construction
Material: aluminium, stainless steel (AISI 304)
Angle free adjustable!



BARRIER-R51

End seal BARRIER-R51

Material: aluminium, stainless steel (AISI 304)
end seal of two rail pipes BARRIER-R11
Projection of the rail pipe max. 500 mm!



Components

BARRIER-R70

Pipe bracket BARRIER-R70

Material: zinc-aluminium, stainless steel
pipe retainer fo fix the pipes BARRIER-R11



BARRIER-R91

End cap BARRIER-R91

Diameter x thickness: 36 x 2 mm

Packaging unit: 2 pieces

Material: plastic

end cap for rail pipe BARRIER-R11

Projection of the rail pipe max. 350 mm!



Accessory items

BARRIER-A10

Adapter BARRIER-A10

Mountable on: concrete or steel construction

System pitch: 90°, 75°, 60°

Material: aluminium, stainless steel (AISI 304)
for fastening the post BARRIER-S13 to the inside of the
parapet



BARRIER-A11

Adapter BARRIER-A11

Mountable on: concrete or steel construction

System pitch: 90°, foldable

Material: aluminium, stainless steel (AISI 304)
for fastening the post BARRIER-S13 to the inside of the
parapet



BARRIER-A31

Spacer bracket BARRIER-A31

Mountable on: concrete or steel construction

Material: aluminium, stainless steel (AISI 304)

2 different adjustment ranges (65 mm - 105 mm or 100
mm - 145 mm)
for BARRIER-A10 and BARRIER-A11





Head office
INNOTECH® Arbeitsschutz GmbH

Laizing 10
A 4656 Kirchham
T +43 7619 22 1 22 - 0
office@innotech.at
www.innotech.at

Branch Office Switzerland
INNOTECH® Arbeitsschutz GmbH

Seestraße 14b
CH 5432 Neuenhof
T +41 56 41 69 040
office@innotechag.ch
www.innotechag.ch

Branch Germany
INNOTECH® Arbeitsschutz GmbH

In der Steinwiese 5
D 57074 Siegen
T +49 271 23 41 94 - 0
office@innotech.de
www.innotech.de